

**MEMORANDUM**  
**City of Lancaster, California**

Date: April 20, 2005 **REVISED November 17, 2005**

Subject: **Rural LMDs**

---

When reviewing LMD plans conditioned to follow Rural Street Standards (Ordinance No 839), please be sure the following requirement is being addressed:

Ordinance No. 839

16.20.235 Perimeter treatment along arterials for Rural Residential Subdivisions:

**B. Landscape/Pathway Easement Design Standards**

**3. Design Requirements**

- f. Decorative low-level ambient lighting shall be provided along the pathway per the direction of the Director of Public Works.

As discussed with Planning, the ambient lighting shall be a bollard style fixture:

Bollard Model No.VRBIC/100MH120/LG-P/NG-C  
Available from Kim Lighting (661) 968-5666

**OR**

Equivalent

The ambient lighting bollards are to be placed on the sidewalk side of the split rail fence and are to be spaced approximately 100 ft to 120 ft apart. See attached DRAFT Rural Street Standard detail for Meandering Sidewalk.

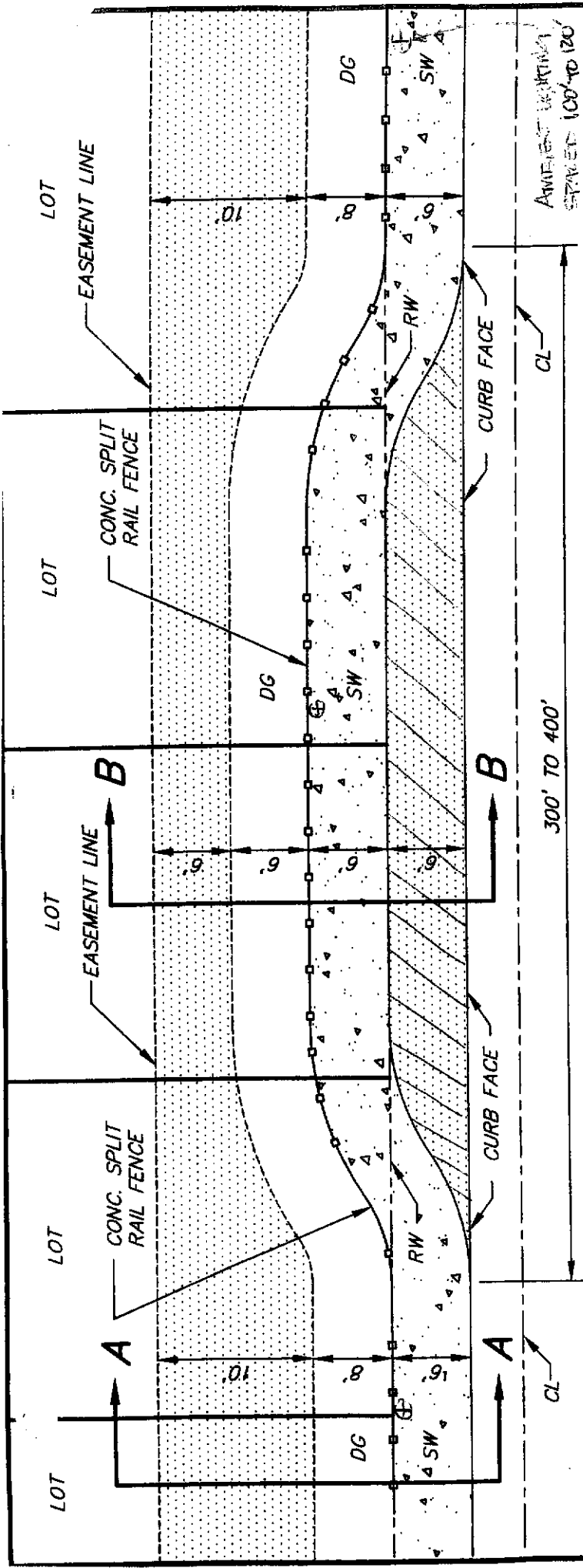

N.T.S.

NO TREES NEXT TO CURBS

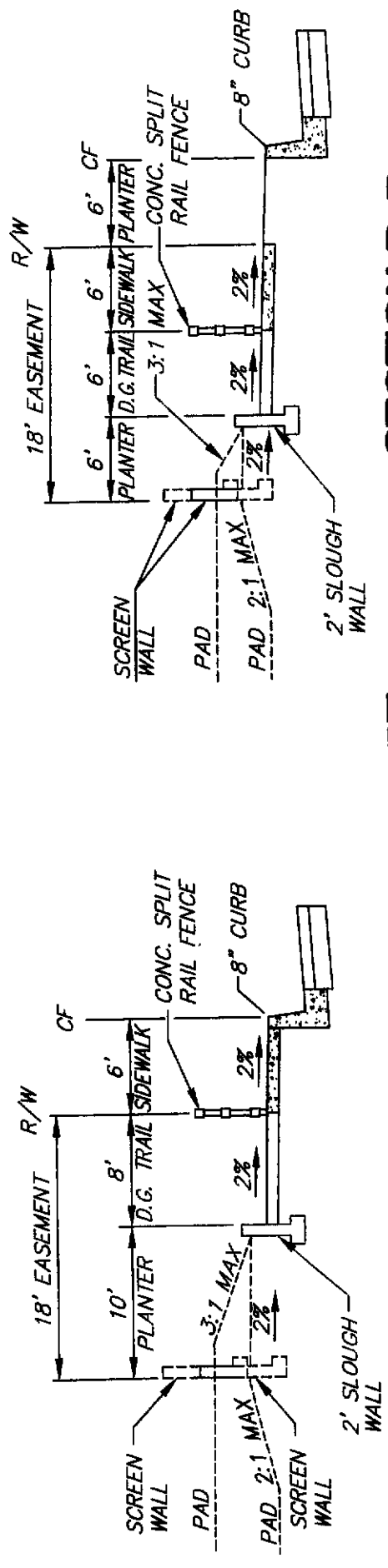

**RURAL STREET STANDARD FOR LMD EASEMENTS  
LANCASTER, CA**